

RF TRANSFORMERS

- RF Transformers
- Impedance=50Ω
- Operating temperature range: -20°C to 85°C
- Storage temperature range: -55°C to +100°C
- RoHS compliant



Electrical Specifications @25 ° C						
Part Number	Turns Ratio	Insertion Loss			DC Current	Frequency
		Pri:Sec(1:3:4:6)	0.03-125MHz	0.04-75MHz		
RFT-018SG	1:1±.5%	3.0dB	2.0dB	1.0dB	30mA	0.03-125MHz

Note: Insertion Loss is referenced to mid-band loss: 0.1dB typ.

MECHANICAL

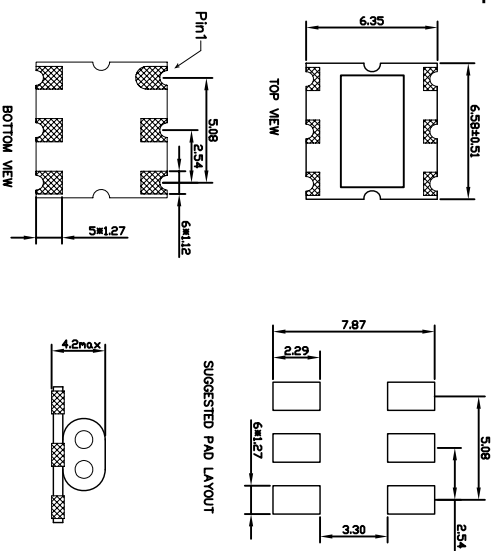

SCHEMATICS

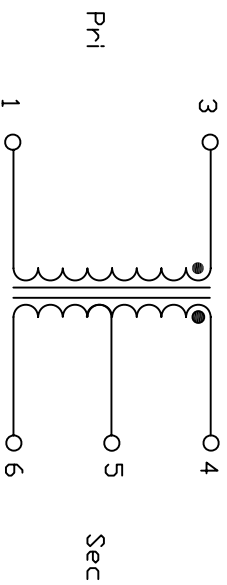

RF TRANSFORMERS

- RF Transformers
- Impedance=50Ω
- Operating temperature range: -20°C to 85°C
- Storage temperature range: -55°C to +100°C
- RoHS compliant



Electrical Specifications @25 ° C						
Part Number	Turns Ratio	Insertion Loss			DC Current	Frequency
		Pri:Sec(1:3:4:6)	0.03-125MHz	0.04-75MHz		
RFT-018SG-C	1:1±.5%	3.0dB	2.0dB	1.0dB	30mA	0.03-125MHz

Note: Insertion Loss is referenced to mid-band loss: 0.1dB typ.

MECHANICAL

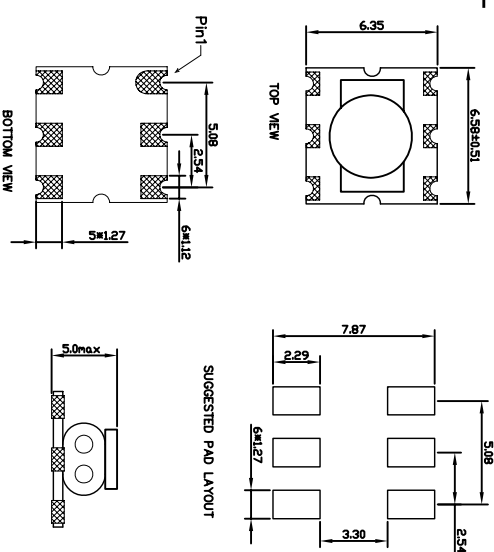

SCHEMATICS

