

- DESIGN FOR PLC(POWER LINE COMMUNICATION) APPLICATION.
- ROHS COMPLIANT.
- SUPPLEMENTARY INSULATION
- OPERATING TEMPERATURE RANGE: -40°C TO +85°C.

Electrical Specifications @25°C							
Part Number	OCL (@100KHz,1V)		LK(@100KHz,1V)	DCR			Hi-pot
	8-5	3-4	3-4	5-8	3-4	1-2	pri to sec 3750VAC/2S
RFT-105SG	1.4uH Min	2.5uH Min	300nH Max	0.095ohm MAX	0.075ohm MAX	0.045ohm MAX	

MECHANICAL DIMENSIONS(unit:mm)

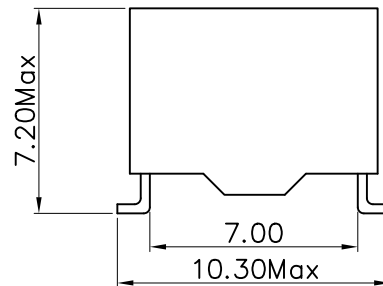
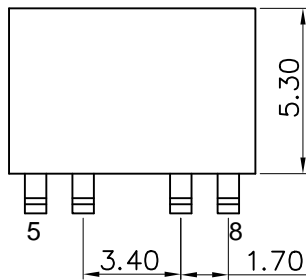
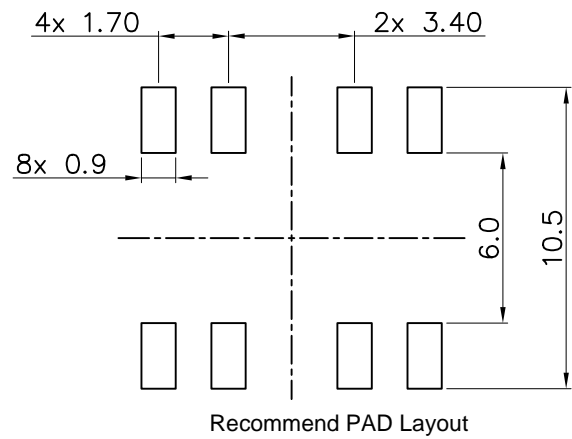
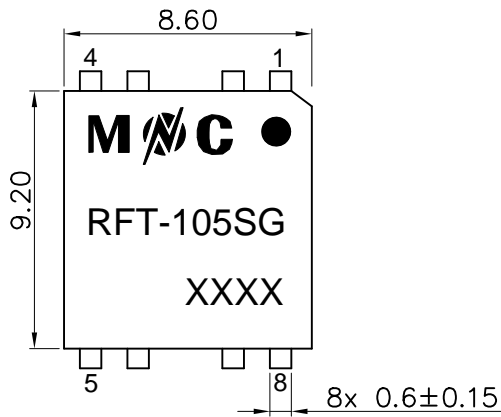

● Unless otherwise specified all tolerances are:±0.25 mm

SCHEMATICS

