

- RF Transformer
- Operating Temperature Range: -20°C to 85°C
- Storage Temperature Range: -55°C to 100°C
- RoHS Compliant



Electrical Specifications @25°C, Z <sub>0</sub> =50Ω								
Part Number	Ω Ratio Pri:Sec(P6-4:P1-3)	Insertion Loss (MHz)			RF Power	DC Current	Frequency (MHz)	Primary Pins
		3dB	2dB	1dB				
RFT-003SG	1:4	-----	0.5-300	1.5-100	0.25W	30mA	0.5-300	6-4

Note: Insertion Loss is referenced to mid-band loss 0.3dB Typ. Measured back to back.

## MECHANICAL

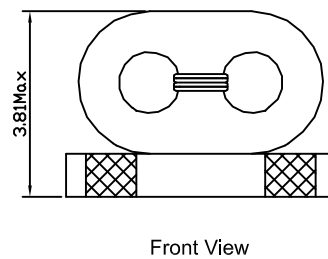
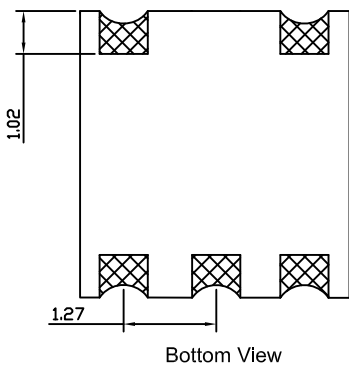
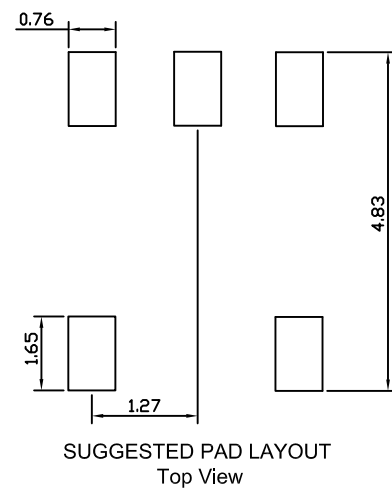
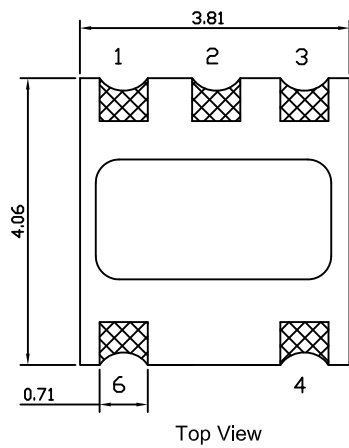

Unless otherwise specified all tolerances are: ±0.25 in mm

## SCHEMATICS

