

- RF Transformer
- Impedance=50Ω
- Operating temperature range: -40℃ to +85℃
- Storage temperature range: -55℃ to +100℃
- RoHS compliant



Electrical Specifications @25℃							
Part Number	Ω Ratio	Insertion Loss			DC Current	RF Power	Frequency
	Sec:Pri(1-3:6-4)	3-800MHz	5-400MHz	10-100MHz			
RFT-080SG	4:1	3.0dB	2.0dB	1.0dB	30mA	0.25W	3-800MHz

Note: Insertion Loss is referenced to mid-band loss, 0.8dB typ.

MECHANICAL

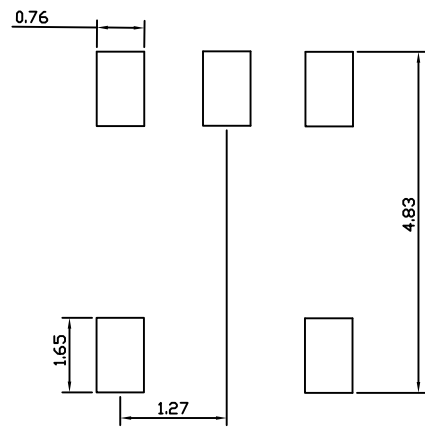
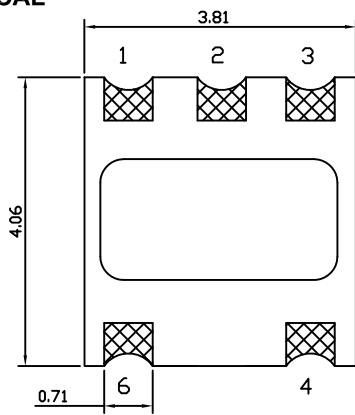

Recommend PAD layout

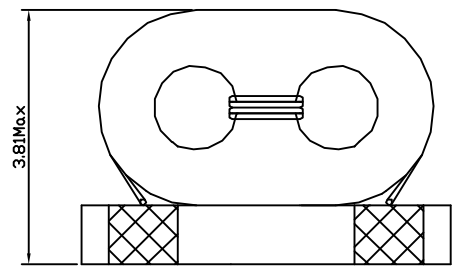
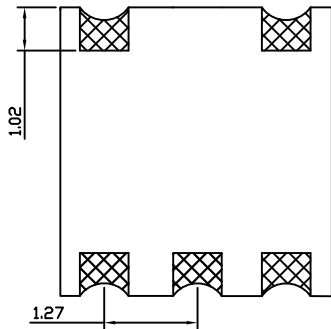

Unless otherwise specified all tolerances are: ±0.25 in mm

SCHEMATICS

